



8, Maddocks Close, Sidcup DA14 5JH  
Guide Price £400,000



Guide Price £400,000-£425,000 Chain free, this well-presented three-bedroom extended end-of-terrace home enjoys a highly convenient position close to local shops, well-regarded schools, Foots Cray Meadows/Five Arches, and excellent transport links. An ideal choice for families, the property offers generous and thoughtfully arranged accommodation, including an entrance hall, a bright reception room, and a newly fitted luxury kitchen/dining room that forms the heart of the home.

Upstairs, you'll find a new family bathroom and three well-proportioned bedrooms. Outside, the property benefits from both front and rear gardens, providing welcome outdoor space. Additional features include double glazing, gas central heating, rewiring to whole house, plumbing for new radiators and 'Vaillant' boiler, fully insulated loft, electricity to shed, outside lighting and tap and a burglar alarm. . With its combination of space, location, and modern finishes, this is a home that deserves to be seen. Viewing is highly recommended.

Local Authority: {prop\_LA\_county}

Council Tax Band: {council\_tax\_band}



# 01322 553322

60-62 High Street, Bexley, Kent, DA5 1AH

bexley@parkestates.co.uk  
www.parkestates.co.uk

## Maddocks Close, DA14

Approximate Gross Internal Area

96.8 sq m / 1042 sq ft

Summer House = 12.0 sq m / 129 sq ft

Total = 108.8 sq m / 1171 sq ft

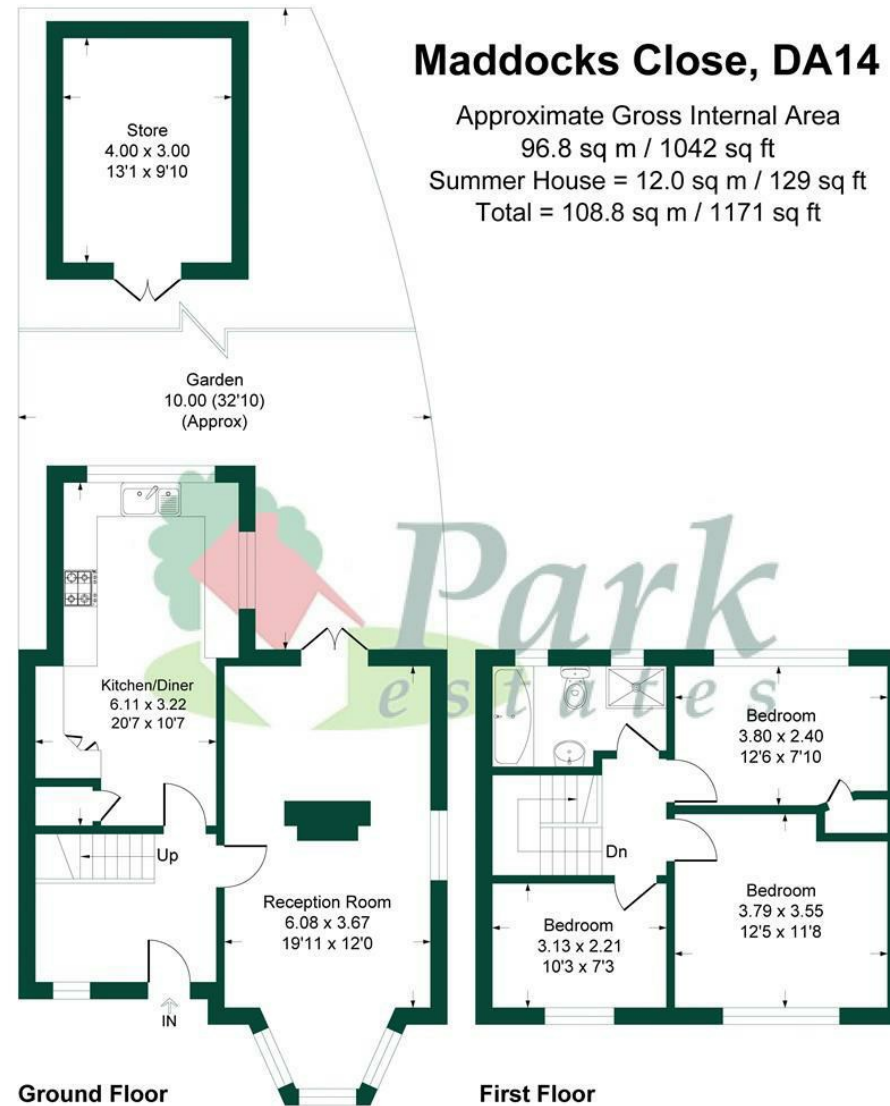

This plan is for layout guidance only. Not drawn to scale unless stated. Windows and door openings are approximate. Whilst every care is taken in the preparation of this plan, please check all dimensions, shapes and compass bearings before making any decisions reliant upon them.  
Produced By Planpix

Every care has been taken with the preparation of details, but accuracy is in no way guaranteed. These particulars do not constitute a contract and are issued and accepted on the express understanding that all negotiations will be conducted through Park Estates. The seller does not make or give, nor do we or our employees have any authority to give a representation or warranty in relation to the property. Please contact this office before viewing the property. If there is any point which is of particular importance to you, we will be pleased to check the information for you and confirm that the property remains available. This is particularly important if you are contemplating travelling some distance to view the property. We would strongly recommend that all the information that we provide about the property is verified by yourself on inspection and also by your conveyancer, especially where statements have been made by us to the effect that the information provided by us has not been verified.